

FOR ADULTS WITH OBESITY (BMI ≥ 30 kg/m²)
OR OVERWEIGHT (BMI ≥ 27 kg/m² to <30 kg/m²) AND A WEIGHT-RELATED COMPLICATION¹
WHO HAVE BEEN PRESCRIBED YURPEAK (TIRZEPATIDE)

once weekly
yurpeak[®]

KwikPen[®]
(tirzepatide) injection

A Lilly Medicine

YURPEAK AND YOU WORKING TOGETHER FOR **WEIGHT LOSS**

See inside:

- What to expect
- Personalized dosing
- How to administer

WEIGHT MANAGEMENT

Yurpeak¹ is approved for the following 2 indications:

1. Type 2 Diabetes

Tirzepatide is indicated for the treatment of adults with insufficiently controlled type 2 diabetes mellitus as an adjunct to diet and exercise

- as monotherapy when metformin is considered inappropriate due to intolerance or contraindications
- in addition to other medicinal products for the treatment of diabetes.

2. Weight management

Tirzepatide is indicated as an adjunct to a reduced-calorie diet and increased physical activity for weight management, including weight loss and weight maintenance, in adults with an initial Body Mass Index (BMI) of

- ≥ 30 kg/m² (obesity) or
- ≥ 27 kg/m² to <30 kg/m² (overweight) in the presence of at least one weight-related comorbid condition (e.g., hypertension, dyslipidaemia, obstructive sleep apnoea, cardiovascular disease, prediabetes, or type 2 diabetes mellitus).



Please review the Prescribing Information and the Instructions for Use, which are included with your medicine, for Important Safety Information and how to use Yurpeak KwikPen.

What Is Yurpeak?¹

Yurpeak is a once-weekly injectable medicine indicated for weight management.

Yurpeak is a **GIP and GLP-1** agonist and **activates both the receptors** in the human body.

Yurpeak is used in addition to a reduced-calorie diet and increased physical activity to help people lose weight.

GIP=glucose-dependent insulintropic polypeptide; GLP-1=glucagon-like peptide-1.



WEIGHT MANAGEMENT

How Yurpeak

Helps your patients

Yurpeak works with your body to help reach your weight-loss goals by:



Decreasing your body weight¹



Lowering your body fat¹



Reducing your appetite and food intake¹



Reducing your cravings for sweets and other high-carb foods²

Yurpeak can also increase feelings of fullness after eating.¹

As seen in a 72-week clinical trial

Powerful Weight Loss¹



PEOPLE TAKING
YURPEAK LOST ~ **24** KG
AN AVERAGE OF

on the 15-mg dose*

People taking Yurpeak also
experienced improvements in†:



- **Waist Size**
- **Blood Pressure**
- **Cholesterol**
- **Triglycerides**

*Throughout a 72-week study of 2539 adults with obesity or with overweight and a weight-related medical problem without diabetes, people taking Yurpeak experienced significant weight loss. Individual results may vary. Weight loss was 16.0% (16.1 kg) for 5 mg, 21.4% (22.2 kg) for 10 mg, 22.5% (23.6 kg) for 15 mg, and 2.4% (2.4 kg) for placebo.

†Yurpeak is not approved for the treatment of high cholesterol, high triglycerides or high blood pressure. Changes occurred during a 72-week clinical trial in people who followed a reduced-calorie diet, increased their physical activity, and took Yurpeak.

WEIGHT MANAGEMENT

once weekly
yurpeak[®]
KwikPen[®]
(tirzepatide) injection
A Lilly Medicine

Yurpeak Offers Convenient, Personalised Dosing¹

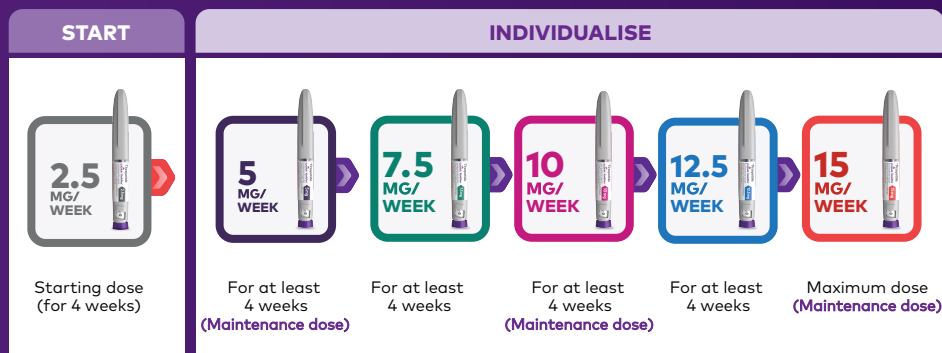

Find the dose that's right for you

With multiple options, you and your doctor can work together to find the once-weekly dose of Yurpeak that is right for you.

- Begin treatment at a once-weekly starting dose of 2.5 mg. After 4 weeks, your doctor will increase your dose to 5 mg.¹
- After another 4 weeks, your doctor may keep you at the 5-mg dose or, if needed, increase the dosage in 2.5 mg increments after at least 4 weeks on the current dose.¹
- Keep up with your plan: You'll work with your doctor to follow this step-by-step dosing process to meet your treatment goals.

If you miss a dose:

- If you forget to inject a dose and it has been 4 days or less since you should have used Yurpeak KwikPen, take your dose as soon as you remember. Then inject your next dose as usual on your scheduled day.¹
- If it has been more than 4 days since you should have used Yurpeak KwikPen, skip the missed dose. Then inject your next dose as usual on your scheduled day.¹

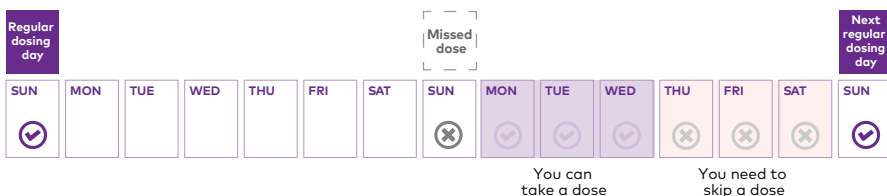

Yurpeak

Multi-Use KwikPen and Storage¹

Yurpeak Kwikpen is a multi-dose pre-filled pen

- The pen contains 4 fixed doses, 1 dose taken weekly. Inject a single weekly injection under the skin (subcutaneously).
- Each pen is for 1 patient only and should not be used by anyone other than you, even if the pen needle has been changed.

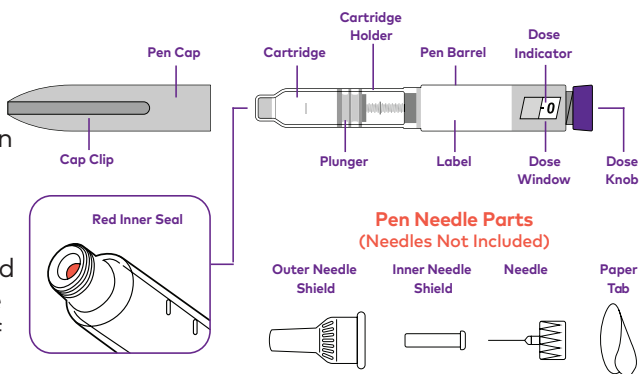

Storing unused Yurpeak KwikPen

- Unused Yurpeak KwikPens may be used until the expiration date printed on the label only if the Yurpeak KwikPen has been kept in the refrigerator.
- Do not freeze your Yurpeak KwikPen. Throw away (discard) the Yurpeak KwikPen if it has been frozen.

Storing used Yurpeak KwikPen

- After first use, patients can store their KwikPen at room temperature (up to 30°C), and it should be used within 30 days from that initial use.
- Keep your KwikPen away from heat. Keep your KwikPen and needles out of the sight and reach of children.
- Throw away the Kwikpen 30 days after first use even though the KwikPen has medication left in it.
- Throw away the KwikPen after receiving 4 weekly doses.
- After the fourth dose, the remaining medication in the KwikPen is not a full dose and should not be administered. The pen also locks by itself to prevent a full dose administration.

Preparing to Use a Yurpeak KwikPen¹

Pick your day. Follow the steps.

Pick a day that works for you:

Take Yurpeak KwikPen at any time of the day with or without meals on the same day each week. It may help to set a reminder on your phone or calendar for this day. If you need to change the day, make sure at least 3 days have passed since your last injection.

You will also need:

- Alcohol Swabs
- KwikPen compatible needle
(Not Provided with
Tirzepatide KwikPen)
- Gauze or cotton ball
- A puncture-resistant container
for throwing away KwikPens

Leftover Medicine after 4th Dose

Each KwikPen delivers 4 fixed weekly doses. Discard after 30 days, even if medicine remains **(this is expected)**. The residual amount does not constitute an additional dose and should not be administered to the patient.

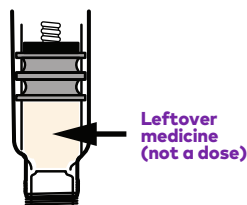

Disposal of Yurpeak KwikPen and needles:



Throw away your used needle in a **puncture-resistant container**.

Throw away the used pen in your household waste or a **puncture-resistant container**.

How to Inject Yurpeak KwikPen

Step-by-Step Instructions¹

Prepare the injection



Step 1: Wash your hands with soap and water

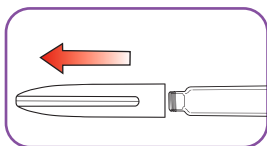

Step 2: Pull the cap straight off and inspect pen and label

Do not use if:

- The medicine name or dose strength does not match your prescription
- The pen is expired (EXP) or looks damaged
- The medicine has been frozen, has particles, is cloudy, or is discoloured. Yurpeak should be colourless to slightly yellow.

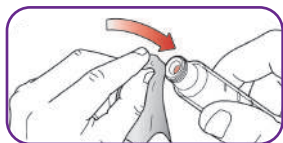

Step 3:

- Wipe the red inner seal with an alcohol swab

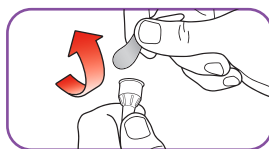

Step 4: Select a new needle

- Always use a new pen needle for each injection to help prevent infections and blocked needles.
- Pull off the paper tab from the outer needle shield.

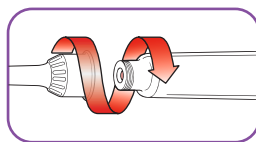

Step 5:

- Push the capped pen needle straight onto the pen and twist the pen needle on until it is tight.

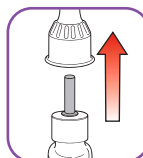

a. Outer needle shield

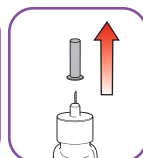

b. Inner needle shield

Step 6:

- Pull off the outer needle shield and keep it (this will be reused). Pull off the inner needle shield and place in your household trash



Scan here to
watch the injection
training video

Prime the Yurpeak KwikPen

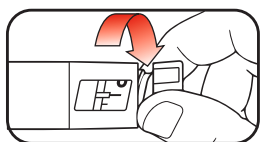

Prime
Position

Step 7:

- Slowly turn the dose knob until you hear **two clicks** and prime extended line/prime position is shown in the dose window.

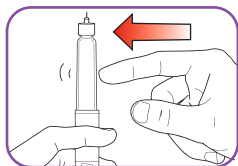

You should prime before each weekly injection to remove air from the cartridge and make sure that your pen is working correctly.

Step 8:

- Hold your Yurpeak KwikPen with the needle pointing up.
- Tap the cartridge holder gently to collect air bubbles at the top.

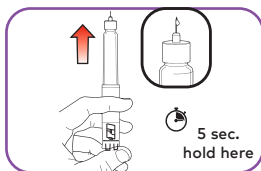

Step 9:

- Release some medicine into the air by **pushing the dose knob in** until it stops, **then slowly count to 5 while holding the dose knob**. The **0** icon must be shown in the dose window. **Do not** inject into your body yet.
- Your pen has been primed if a small amount of medicine comes out the tip of the pen needle.
- If you do not see medicine, repeat steps 7-9, no more than 2 additional times.
- If you still do not see medicine, then change the pen needle and repeat steps 7-9, no more than 1 additional time. If you still do not see medicine, contact your local Lilly office.

Inject Yurpeak KwikPen

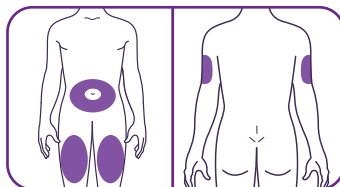

Step 10: Choose an injection site

- You or another person can inject the medicine in your thigh or stomach (abdomen) at least 5 centimeters from the belly button. Or, another person should give you the injection in the back of your upper arm
- Change (rotate) your injection site each week. You may use the same area of your body but be sure to choose a different injection site in that area.

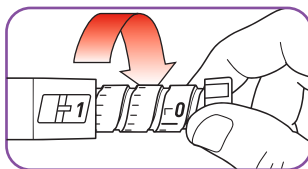

Step 11: Turn the dose knob

- Turn the dose knob until it stops and the 1 icon is shown in the dose window.** The **1** icon is equal to a full dose

For each weekly injection, the **1** should be shown in the dose window. **1** = 1 Full dose

once weekly
yurpeak[®]
KwikPen[®]
(tirzepatide) injection
A Lilly Medicine

How to Inject Yurpeak KwikPen (cont'd)

Step-by-Step Instructions¹

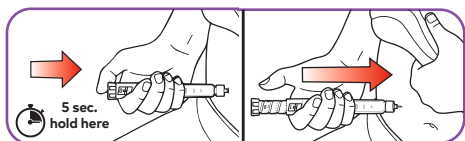

Step 12:

- Insert the needle into your skin
- Inject the medicine by **pushing the dose knob in** until it stops, then **slowly count to 5 while holding the dose knob**.

You will know your injection is completed when you see the **0** icon in the dose window.

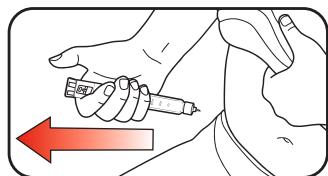

Step 13:

- Pull the needle out of your skin. A drop of medicine on the needle tip is normal. It will not affect your dose
- Confirm the **0** icon is in the dose window, if you see the **0** icon in the window, you have received the full dose.
- If you do not see the **0** in the dose window, insert the needle back into your skin and finish your injection. Do NOT redial the dose. If you still do not think you received the full dose, **do not** start over or repeat the injection. Contact your local Lilly office listed in the patient information leaflet.

After your Yurpeak KwikPen Injection

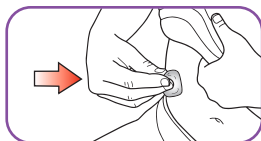

Step 14:

- If you see blood after you pull the needle out of your skin, lightly press the injection site with gauze or a cotton ball. **Do not** rub the injection site

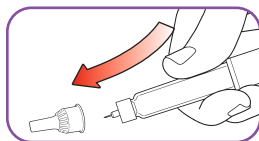

Step 15:

- Carefully replace the outer needle shield.

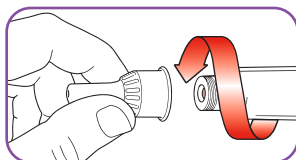

Step 16:

- Unscrew the capped needle, and put the needle in a puncture-resistant container. **Do not** store the pen with the needle attached to prevent leaking, blocking the needle, and air from entering the pen.

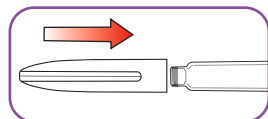

Step 17:

- Replace the Yurpeak KwikPen cap. **Do not** the KwikPen without the pen cap attached.

Tips for Managing Gastrointestinal Symptoms

As with all medicines, you may feel side effects with Yurpeak.¹

The **most frequently** reported adverse reactions in a clinical trial were **gastrointestinal disorders, including nausea, diarrhoea, constipation, and vomiting.**

In general, these reactions were mostly mild or moderate in severity and occurred more often during dose escalation and decreased over time.¹

Tips for managing gastrointestinal symptoms

If you have nausea after taking Yurpeak, talk to your healthcare provider. In the meantime, these tips may help:

- Try eating smaller, more frequent meals.³
- At mealtimes, focus on recognising when you feel full so you know when to stop eating. This may help you manage or prevent gastrointestinal symptoms.⁴
- Avoid foods and beverages which might worsen symptoms, such as high-fat or fried foods, spicy foods, alcohol, or carbonated beverages, to help reduce symptoms like nausea and heartburn.⁴
- Stay hydrated and gradually incorporate more fibre into your diet to help reduce constipation.⁴

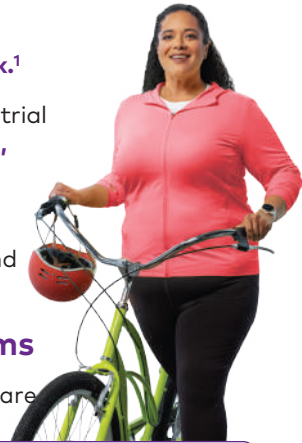

Additional Information¹

Dehydration

When starting Yurpeak, you may lose fluids due to nausea, vomiting, or diarrhoea, which can affect kidney function. It is important to drink plenty of fluids to stay hydrated and reduce this risk.

Hypoglycaemia

Yurpeak has a low risk of causing low blood sugar (hypoglycaemia). However, if you're also taking sulfonylureas or insulin, your risk increases. Your doctor may adjust those medications before starting Yurpeak. Symptoms of low blood sugar include headache, dizziness, hunger, confusion, and sweating. Talk to your healthcare provider about how to manage it.

If you experience or have ever experienced any of the following, please speak to your healthcare provider immediately:

- Severe pain in the stomach and back that does not go away This can be a sign of pancreatitis (inflammation of your pancreas)
- An allergic reaction after taking this medicine.

YOU ARE NOW READY FOR YOUR WEIGHT-LOSS JOURNEY WITH YURPEAK¹

WEIGHT MANAGEMENT

Where to learn more:

- Scan the QR code to access your digital Starter kit including:
 - The injection training video
 - Additional tips on getting started
- Speak to your healthcare provider.
- Read the Prescribing Information and Instructions for Use that come with your medicine.



References: 1. Yurpeak® (tirzepatide), India Prescribing Information, Updated March 2025 2. Martin CK, Ravussin E, Sanchez-Delgado G, et al. 128-OR: the effect of tirzepatide during weight loss on food intake, appetite, food preference, and food craving in people with obesity. *Diabetes*. 2023;72(suppl1):128-OR. doi:10.2337/db23-128-OR 3. Gorgojo-Martínez JJ, Mezquita-Raya P, Carretero-Gómez J, et al. Clinical recommendations to manage gastrointestinal adverse events in patients treated with GLP-1 receptor agonists: a multidisciplinary expert consensus. *J Clin Med*. 2023;12:145. doi:10.3390/jcm12010145 4. Wharton S, Davies M, Dicker D, et al. Managing the gastrointestinal side effects of GLP-1 receptor agonists in obesity: recommendations for clinical practice. *Postgrad Med*. 2022;134:14-19. doi:10.1080/00325481.2021.2002616

The information provided in this material is intended solely for the use of registered medical practitioner. This material is being provided to healthcare professionals for their guidance and use. Nothing on this material should be construed as giving medical advice or making recommendations regarding any health-related decision or action. This material can be used by the Healthcare professional who shall exercise his/her own independent judgement and discretion to disseminate the material to their patients who have been prescribed Yurpeak(tirzepatide). This material has been developed by Cipla under the distribution and promotion license agreement with Eli Lilly. Cipla and Eli Lilly will not be liable for any outcomes due to the inaccurate use of the information provided under this material. Without limitation, the information provided should not replace medical advice received from a healthcare provider or treating doctor. This material (including any link) is intended solely for the use of the recipient(s) and may contain confidential information. Any unauthorized review, use, disclosure, copying, or distribution is strictly prohibited. If you are not the intended recipient, please notify the sender immediately and destroy all copies of the material. Yurpeak® is a registered trademark owned by Eli Lilly. Promoted and Distributed by Cipla Limited in India. To be sold by retail under prescription of Endocrinologist or Internal Medicine Specialists only. For any further information, please contact : Cipla Ltd., Cipla House, Peninsula Business Park, Ganpatrao Kadam Marg, Lower Parel, Mumbai-400013, India | www.cipla.com



For Tirzepatide Prescribing Information,
please scan QR code. Additional
information is available on request.

once weekly
yurpeak[®]
KwikPen[®]
(tirzepatide) injection
A Lilly Medicine